

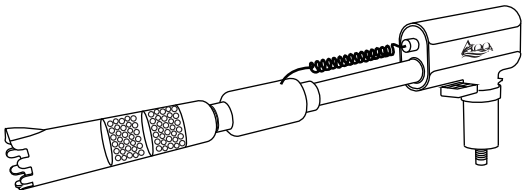

# USER MANUAL

## AQQA Automatic Aquarium Water Changer AQ-119



AQQA automatic aquarium water changer is a versatile tool to remove waste , wash sand, water draining as well as adding water right back into the aquarium. It can replace traditional Siphon cleaning tool. Please read this user manual carefully before using and follow in strict accordance with the manual.

# 1. PRODUCT FEATURES:

## **Unique patented design with an adjustable clip-on handle:**

This is a new type of water changer, avoid using the siphon needed to achieve a height difference with the traditional water changer. It is widely used and more unique. The built-in dual circuit operating mode and the appealing appearance is much different from current ones. The adjustable clip-on handle can free your hands is suitable for both frameless and framed fish tanks.

**Multi-functional use:** Our water changer can be utilized to drain and add water, remove detritus sand clean.

**Adjustable water rate:** The water pump provides 3 different water rate and power display for user to adjust.

**Optional 2 PCS extension tubes:** The Aquarium water changer with two extension tubes can create a total depth of 37.4(95cm) inches. The tube can be extended from 21.6(55cm) inches to 37.4(95cm) inches, which allows a wide range of aquarium applications.

**Easy to operate and durable:** AC/DC safe power supply, worry-free, not restricted by the use of the site. At the same time, the water changer can keep working for 1 ~2 hours, which can meet the demands of fish tanks of different sizes.

# 2. PRODUCT PARAMETERS:

	US Standard	EU/UK Standard
Model:	AQ119	
Power:	15W	
Voltage:	DC12.6V	
H max:	8ft	2.5M
Q max:	420GPH	1600L/H
Line Length:	4.9ft	1.5M
Outlet Hose:	Outer Dia: 3/4 inch Inner Dia: 1/2 inch	Outer Dia: 18MM Inner Dia: 14MM

### 3.Accessories and Assemble Instruction:

A) Accessories included:

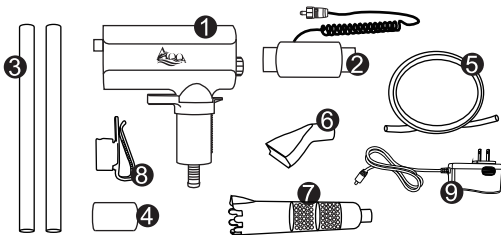
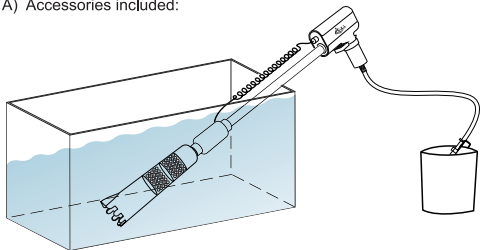

1. Water Changer with clip on handle

3.2pcs extension tube

5.6.5ft(2M) PVC outlet tube

7.Sand washing head

9.12.6V adapter

2.Water pump with spring cord

4.Connector

6.Feces suck head

8.Bucket plastic clip

Indicator light 2 modes:

Mode #1: Red flash 10s means that you can adjust water rate from 1 to 3 gears.

Mode #2: The red light does not flash means the power is fully charged.

The water changer has two circuit designs, so it can also be used when power is off, achieving worry-free use. The adapter's indicator light turns red when it works and light turns green when it stops working.

DC 12.6V Input

Adjustable water rate button:  
turn right or turn light to adjust  
according to customer's needs.

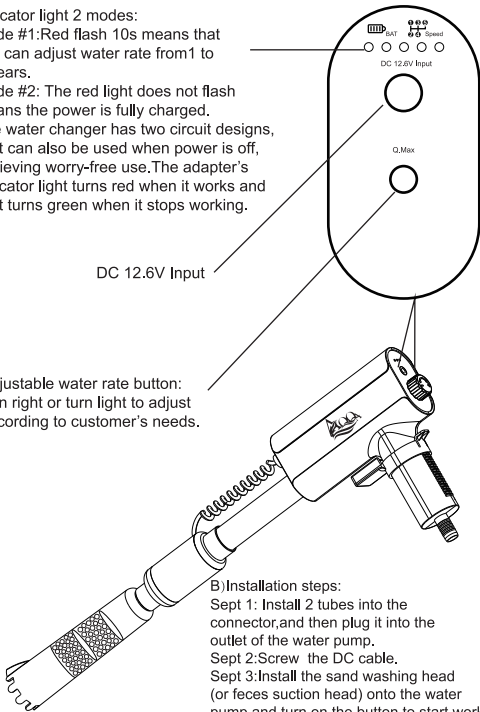

B) Installation steps:

Sept 1: Install 2 tubes into the connector, and then plug it into the outlet of the water pump.

Sept 2: Screw the DC cable.

Sept 3: Install the sand washing head (or feces suction head) onto the water pump and turn on the button to start work.

## Important Attention:

✓ Install the cable into the correct bayonet and lock with the plastic screw. Please refer to the pictures below:

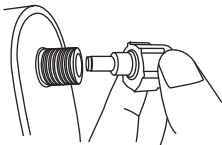

✓ The Aqqa's cable or adapter cannot be matched with other brand's products, otherwise, accidents are likely to occur.

✓ The DC 12.6V input and DC 12V output are not water proof.

✓ When the air pump is idle for a long time, it needs to be plugged in and used for 8-10hours every 1-2 months.

✓ Please do not immerse the outlet pipe into the water or fill the outlet pipe with water when opening the water changer, which will lead to the failure of water suction under the condition of power working.

If there is air leaking into the inlet pipe accidentally, there will be no water coming out of the water changer. Please drain the water in the water inlet pipe and the water outlet pipe, and then restart the water changer to work normally.

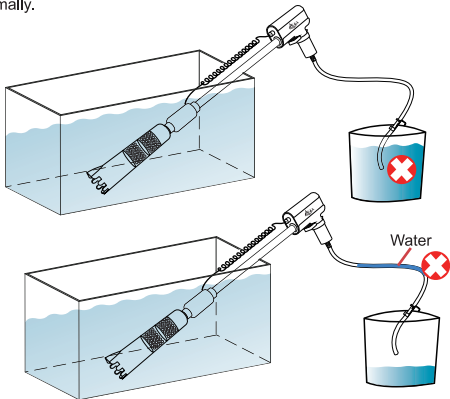

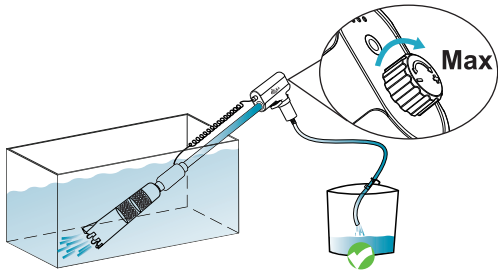

**4.WARNING:** To guard against injury, basic safety precautions should be observed including the followings:

1. Read and follow this user manual strictly.
2. **DANGER-**To avoid possible electric shock, special care should be taken since water is employed in the use of aquarium equipment. For each of the following situations, do not attempt to repair yourself; return the pump to an authorized service facility for service or discard the pump.
  - A. If the pump shows any sign of abnormal water leakage or RCD (or GFCI-Ground Fault Current Interrupter), unplug from power and remove the pump from water.
  - B. Carefully examine the pump after installation. It should not be plugged in if there is water on parts not intended to be wet.
  - C. Do not operate the pump if it has a damaged cord or plug, if it is malfunctioning or if it is dropped or damaged in any manner. The power cord of this pump cannot be replaced, if the cord is damaged, the pump should be discarded.
  - D. To avoid the possibility of the pump plug getting wet, position aquarium stand and tank to one side of a wall mounted outlet to prevent water from dripping onto the outlet or plug. A "drip loop", shown in the figure below, should be arranged by the user for each cord connecting the pump to the outlet. The "drip loop" is the part of the cord below the level of the outlet, or the connector. If an extension cord is used, to prevent

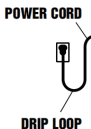

water traveling along the cord and coming in contact with the outlet. If the plug or outlet does get wet, DO NOT unplug the cord. Disconnect the fuse to the circuit breaker that supplies power to the pump. Then unplug and examine for the presence of water in the outlet.

3. Close supervision is necessary when the pump is used near children.
4. This pump is not allowed to use by persons (including children) with reduced physical, sensory or mental capabilities, or lack of experience and knowledge, unless they have been given supervision or instruction concerning use of the pump by a person responsible for their safety.
5. To avoid injury, do not contact moving parts or hot parts.
6. Always unplug the pump from the outlet when not in use, before putting on or taking off parts, and before maintenance or placing hands in the water. Never yank the cord to pull plug from outlet. Grasp the plug and pull to disconnect.
7. Do not use the pump for other than intended use. The use of attachments not recommended or sold by the appliance manufacturer may cause an unsafe condition.
8. Do not install or store the pump where it will be exposed to the weather or to temperatures below freezing. This pump is suitable for use in water temperatures 40~ 95 °F (4.5~35 °C).
9. Do not submerge more than 3ft of water depth.
10. Do not run dry or out of water. Keep water pump completely submerged.
11. Only use in freshwater or saltwater, do not use the pump in other liquids.
12. Make sure the pump is securely installed before operating.
13. Read and observe all the important notices on the pump.
14. If an extension cord is necessary, a cord with a proper rating should be used. A cord rated for less amperes or watts than the appliance rating may overheat. Care should be taken to arrange the cord so that it will not be tripped over or pulled.
15. The pump is intended FOR HOUSEHOLD USE ONLY. Do not use or mount this pump in such a way that the top vents are restricted or blocked. These vents are necessary to avoid overheating and ensure safe operating temperatures.
16. All pumps are professionally water tested by the manufacturer before shipment; if the water pump you received has a little water, please don't worry, this is the result of the testing process. You are receiving a brand new pump.
17. SAVE THIS USER MANUAL.

## **5. PACKAGE INCLUDES:**

- |                                     |                      |                |
|-------------------------------------|----------------------|----------------|
| 1x water pump with spring wire cord |                      |                |
| 2x extension tube                   | 1x sand washing head |                |
| 1x feces suck head                  | 1x adapter           | 1x user manual |

## 6.Troubleshooting:

	Reasons	Solution
Pump stopped working	1.The power is not connected 2.Water pump damaged 3.Impeller blocked 4.Out of the water	1. Plug in power 2. Replace water pump 3. Take it out and clean motor 4. Submerge it completely
Noise	Motor blocked Motor worn out or broken	Take it out and clean motor Replace motor
Insufficient water flow	Impeller damaged	Replace impeller

**If you have any problems or suggestions for the water changer , please contact us by email before leaving feedback or opening a case, it will be the fastest way to solve your problem.**

**If you are satisfied with the water changer, please leave positive feedback for our product, in order to let more customers enjoy it.**

**Thanks again!**

Company Name :Shenzhen Aiku Pet Technology Co.,Ltd

Address:Room 501,No.20,Lane 1,Lishipai,Dafapu Community

Bantian Street,Longgang District ,Shenzhen Guangdong. 518000

Hotline:888-666-0582(Free call in US)

Email:service@aqqapet.com

Website:<http://www.aqqapet.com>



Company name:Like Sun GmbH  
Address:Planckstr.59 45147 Essen  
Email:ec-connection@web.de  
Tel:+49 47139156605



Company name:KOVA ASSOCIATES LTD  
Address:72a Kingston Road,Portsmouth,  
Hampshire,PO2 7PA,United Kingdom  
Email: KOVA.Compliance@outlook.com  
Tel:0044(0)23 8097 0315

