

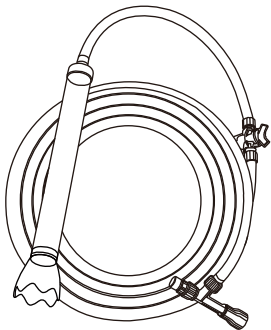

AQQA Aquarium Siphon Vacuum Water Changer AQ-027



Thanks for buying AQQA product. To ensure you use the product safely and correctly, please read carefully and thoroughly this instruction and save it for future use.

1.PRODUCT FEATURES:

1) Multi-function cleaning and water changer:Auto draining and can be used for water changes, sand washing and detritus absorption.

2)Unique Design:Special structure for the siphon, Long tube is convenient for long-distance cleaning and water change.

3)Multi-function Thread sizes:Three different sizes of threads can be applicable to variety of faucets.

4)Durable plastic parts:High-quality plastic connectors.

2.PARAMETER:

Model	Length of tube	Size of Hose	Size of thread	Thickness of glass is applicable
AQ-027-25FT	25FT	Φ1/2" x 5/8"	Φ1/2" x 5/8"	≤3/8"
AQ-027-50FT	50FT	Φ1/2" x 5/8"	Φ1/2" x 5/8"	≤3/8"

3.METHOD OF APPLICATION:

Accessories Included:

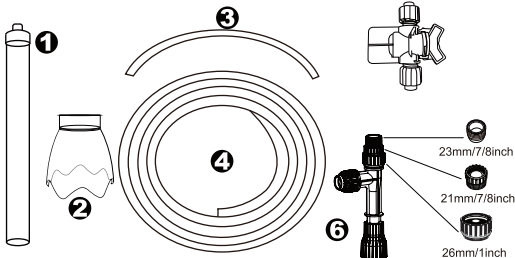

1 Vacuum Tube

4 25Ft/50Ft PVC hose

2 Intake strainer

5 Manual valve

3 1.8Ft PVC hose

6 Faucet adapter

4.INSTALLATION INSTRUCTIONS:

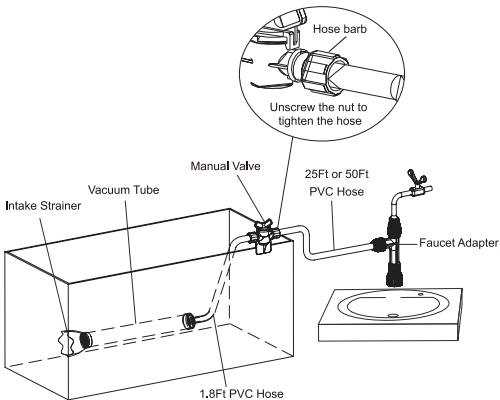

Function A: Cleaning aquarium by Siphoning.

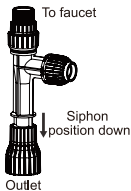

Step 1: Connect faucet adaptor to faucet and install 25ft/50ft PVC tube .

Step 2: Connect both 25ft/50ft PVC hose and 1.8ft PVC hose onto manual valve ,and hold them onto the aquarium tank with vacuum tube.

Step 3: Pull Siphon position down and be sure the manual valve is open, then turn on water faucet,so siphoning start to wash sand and absorb detritus. Meanwhile the water will be flowing through the the outlet of faucet adaptor.

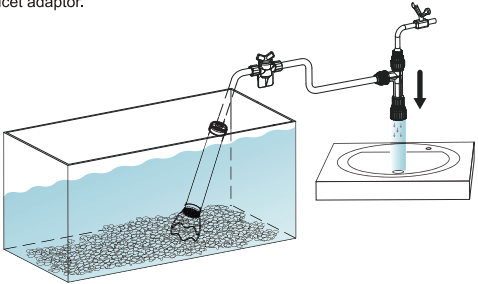

Important reminder:

1)Before attaching the hose to the faucet adaptor,make sure the nut is unscrewed.

When assembling the 1.8ft PVC hose and 25/50Ft PVC hose to the manual valve,make sure the tubing firmly attaches to the hose barb, then unscrew the nut from the manual valve to tighten it over the hose.

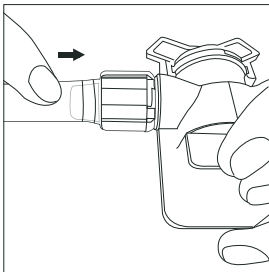
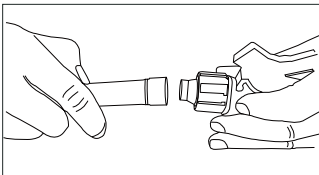

Firmly attaches as possible as you can

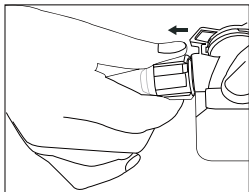

Screw the hose barb backward

Function B:Filling

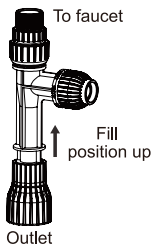

1)Connect faucet like Function A.

2)Push fill position up and rotate the outlet, turn on the faucet so that the water is diverted to the PVC hose and fill the aquarium.

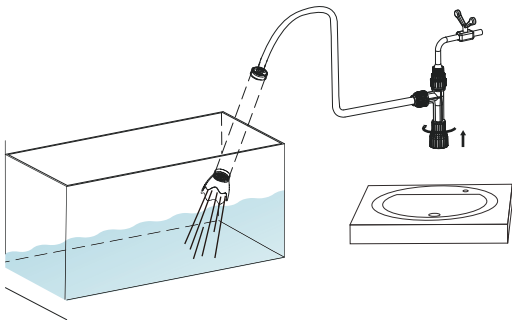

5.ADVISE FOR FILLING WATER ACTION:

1)To help maintain a healthy aquarium, change out 10% of the water weekly or 25% monthly.

Use a water conditioner(sold separately)every time you add fresh tap water to your aquarium.

2)When filling aquarium,make sure the water temperature is the same as the water in the aquarium.Fill the tank slowly so that an temperature adjustment can be made.

6.ATTENTIONS:

Please read this user manual carefully before use and follow strictly in accordance with the manual.

- ✓ Keep away from children.
- ✓ Ensure the gravel tube valve is closed before using the aquarium gravel vacuum.
- ✓ Do not use the gravel cleaner in flammable or corrosive liquid.
- ✓ Do not use the gravel cleaner water that is too hot or too cold (temperature above 96°F or under 32°F) as it will damage the cleaner.

7.PACKAGE INCLUDED:

- 1× Gravel Vacuum Tube $\Phi 1 \frac{3}{8}$ inch
- 1× Water Manual valve
- 1× Multi-connection faucet adaptor
- 2*PVC Hose $\Phi 1/2 \times 5/8$ (12*15mm)
- 1× Debris Vacuum Header
- 1x User Manual

8.WARRANTY

1. 1-year free warranty.
2. 1-month free return.
3. Free replacement for 3 months.

9.CONTACT INFORMATION:

Company Name :Shenzhen Aiku Pet Technology Co.,Ltd
Add:Room 501,No.20,Lane 1,Lishipai,Dafapu Community
Bantian Street,Longgang District ,Shenzhen Guangdong. 518000
Hotline:888-666-0582(Free call in US)
Email:service@aqqapet.com

Thank you for choosing AQQA, making fish keeping easier!
If you have any problems or suggestions for the water changer, please contact us by email before leaving feedback or opening a case, it will be the fastest way to solve your problem.
If you are satisfied with the water changer, please leave positive feedback for our product, in order to let more customers enjoy it.
Thanks again!