

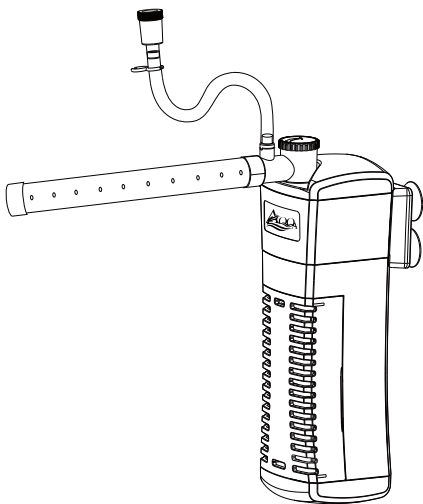

AQQA 5 in1 AQUARIUM INTERNALPOWER FILTER AQ-025

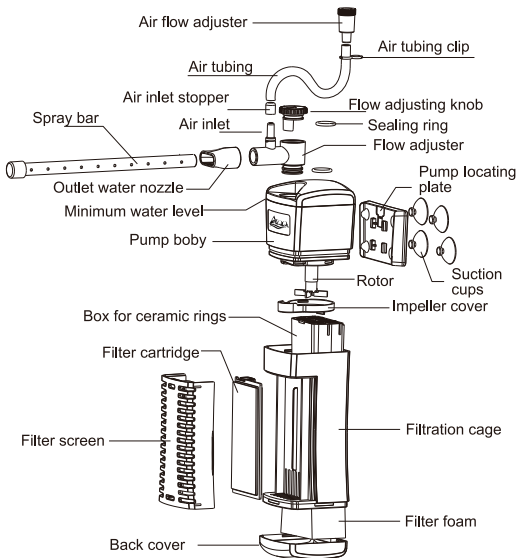

Thanks for buying this AQQA product. To ensure you use the product safely and correctly, please read this manual carefully and thoroughly and save it for future use.



1.PRODUCT FEATURES

1) 5 in1 Multi-functions:The filter foam provides efficient mechanical filtration; The activated carbon traps particles and removes odors;

The ceramic rings provide large surface area for growth of beneficial bacteria, which degrades harmful impurities and help maintain the ecological environment in aquariums;

The filter has a cartridge for pre-filtration. The cartridge is very easy to replace, providing great convenience to the users for maintenance.

Water outlet can be used for the wave maker.

Air inlet increases the amount of oxygen in the water.

2) Unique and Novel Appearance Design:Special structure for above and below draining, small shape saves your tank space . Humanized disassembly and assembly design, easy to use.

3) Adjustable Flow Rate: Two options for water draining and wave maker can adjust the flow rate for your fish and turtle.

4) Super Silent:High-quality silent and durable pump. Stainless Steel motor impeller can be used for freshwater and salt water.

2.METHOD OF APPLICATION:

The filter can be used in multiple options.

Option 1

- 1)Connect the outlet water nozzle to the outlet of the filter.
- 2)Fix the filter to the wall of the aquariums with the suction cups.
- 3)Make sure the filter is fully submerged in water.
- 4)Then connect the filter to the power supply.
- 5)Adjust the direction of the flow left and right with the flow direction adjuster and adjust the flow rate with the flow adjusting knob.

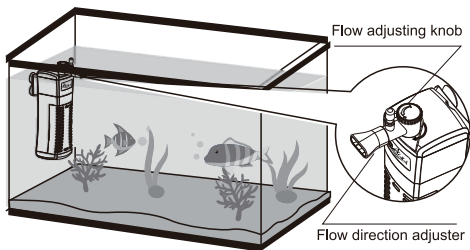

Option 2

With this option, air will be added to the water outlet to create air bubbles, which will help supplement oxygen for fish in aquariums.

- 1)Remove the stopper at the flow adjuster.
- 2)Connect the air tubing to the air inlet and attach the air tubing to the power cord of the pump with the air tubing clip.
- 3)Do the same as option 1 to position the filter in the aquarium.
- 4)Make sure the airflow adjuster is placed outside the water.
- 5)Connect the filter to the power supply.
- 6)Adjust the airflow rate by turning the air inlet adjuster.

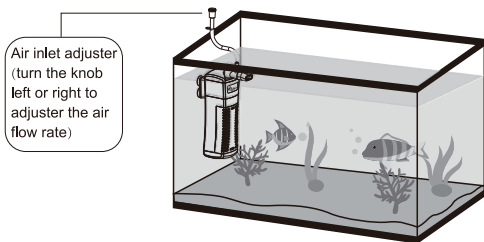

Option 3

With this option, the spray bar sprays water evenly to the surface of the water to help increase oxygen in the water and to agitate the surface water in your aquarium.

- 1) Connect the spray bar with the water outlet as shown in the diagram on the right.
- 2) Do the same as option 1 to position the filter in the aquarium.
Make sure the spray bar is positioned horizontally.

Reminder: Make sure the filter is positioned above the minimum water level.

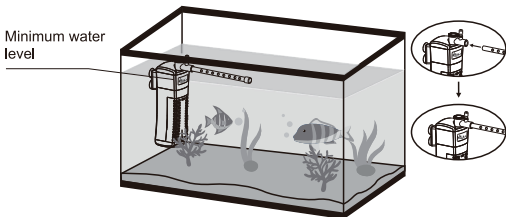

3.REPLACEMENT OF FILTER MEDIA

Attention please! The cartridge filter is suggested to be replaced every 2 weeks to 1 month depending on the number of fish, filthiness, or the extent of degradation.It is not recommended to clean the ceramic rings, just to replace them when they get degraded.

1)Replace the filter cartridge, please follow up the following instructions:

Take off the filtration cage and pull out the filter sheet, place the new replacement in and install.

Reminder: if the water output is significantly reduced, replace the filter sheet to ensure the aquarium is kept in the best condition.

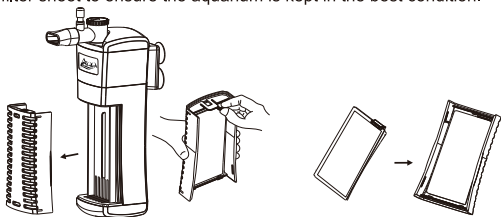

2)Cleaning/Replacing the filter foam

Take off the back cover and take out the filter foam for cleaning, and re-install.

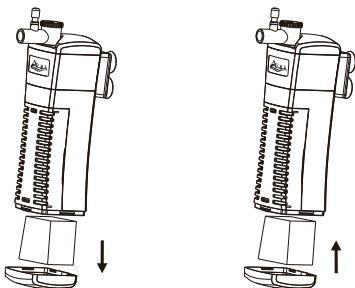

3) Replacing the ceramic rings

Pull out the filter cage from the pump body and take out the replacement ceramic ring and install.

Attention: The best way to remove the cage is in the way of “bending a metal wire”. Do not pull vertically.

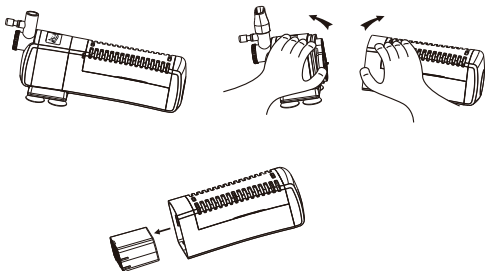

4) Maintenance of the pump

Pull out the filter cage, remove the impeller cover and take out the impeller for cleaning. Then re-install

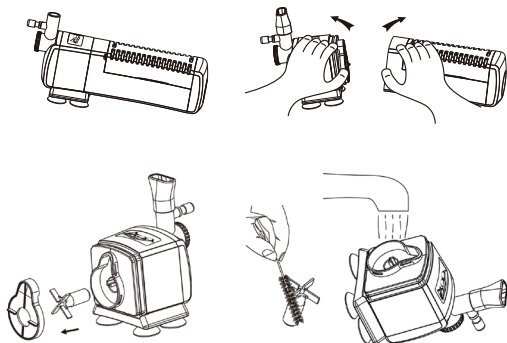

4.PARAMETER:

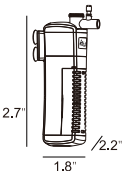
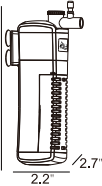
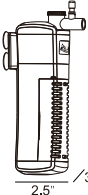
Size	 2.7" 1.8" / 2.2"	 3.7" 2.2" / 2.7"	 8.7" 2.5" / 3"
	2.2X1.8X2.7in	2.7X2.2x3.7in	3x2.5x8.7in
Item No.	AQ-025-S	AQ-025-M	AQ-025-L
Voltage	110-120V		
Frequency	60Hz		
Power(W)	4.5	5.5	8.5
Flow(GPH)	79	120	172
Head(FT)	1.3	2.0	3.0
Recommended Aquarium Size	5-10Gal	10-20Gal	15-30Gal

5.IMPORTANT SAFETY CAUTIONS:

- 1.Please operate the appliance under the rated voltage and frequency indicated on the rating label or instruction manual.
- 2.A 10mA or 30mA residual current device must be fitted to the main power supply.
- 3.The power cord is not replaceable. If the power cord or the plug is found worn or damaged, or the plug is found aged, stop using the filter immediately. Do not attempt to shorten the power cord, or to remove the plug. Failure to meet these points may cause damage to the filter.
- 4.If an abnormal smell or noise is found coming from the filter, unplug it immediately and inspect the cause.
- 5.Make sure your hand and the plug are dry when plugging in or unplugging the filter. It is forbidden to plug or unplug the filter with a wet hand as this might cause an electric shock.

- 6.Unplug the filter before installation and cleaning. Don't pull the power cord abruptly. To unplug, grasp the plug and pull it out from the receptacle gently.
7. Properly protect the filter. If a severe collision happens to the filter, check if there is any damage. If there is any breakage, stop using the filter and destroy it.
- 8.Do not let the filter run dry as this will damage the rotor and will cause overheating of the motor.
- 9.Do not operate or leave the filter in freezing conditions.
- 10.Always keep the filtering part not blocked. Otherwise, the flow rate will be reduced and the impeller will stop working.
- 11.Do not use the filter in inflammable or corrosive liquids. The filter should be operated in an environment less than 104 °F.

Trouble	Solution
Pump doesn't work	The filter is not starting up
	The main power doesn't match
	The power specified on the filter
	Water inlet or outlet is blocked
	The impeller or rotor is damaged
Water flow is reduced	The voltage is lower than the rated voltage
	Water inlet or outlet is partially blocked
	Wastes have accumulated in the filtering system
The filter is noisy	Water inlet is partially blocked
	Water level is lower than the inlet of the filter.
	Air enters into the filter causing noise.
	The rotor is worn (need to be replaced)

6.DISPOSAL

Do not dispose of this product as unsorted municipal waste. Collection of such waste separately for special treatment is necessary. This product must not be disposed of together with the domestic waste. This product has to be disposed of in an authorized place for recycling electrical and electronic appliances.



By collecting and recycling waste, you help save natural resources, and make sure the product is disposed of in an environmentally friendly way.

7.WARRANTY

1. 1-year free warranty.
2. 1-month free return.
3. Free replacement for 3 months.

8. CONTACT INFORMATION:

Company Name:Shenzhen Aiku Pet Technology Co.,Ltd
Add:Room 501,No.20,Lane 1,Lishipai,Dafapu Community
Bantian Street,Longgang District ,Shenzhen Guangdong. 518000
Hotline:888-666-0582(Free call in US)
Email:service@aqqapet.com

Thank you for choosing AQQA, making aquarium keeping easier one product at a time.

If you have any problems or suggestions for the internal power filter, please contact us by email before leaving feedback or opening a case, it will be the fastest way to solve your problem.

If you are satisfied with the internal power filter, please leave positive feedback for our product, in order to let more customers enjoy it.

Thanks again!